

FORMAWALL GRAPHIX SERIES

REVEAL

true vision. true imagination.

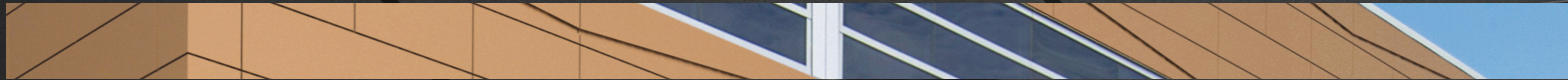

“Architecture should have little to do with problem solving - rather it should create desirable conditions and opportunities hitherto thought impossible.”

— Cedric Price, *The Square Book*

At CENTRIA, we believe it is innovation, paired with a robust imagination, that reveals the true artist in an architect. It is this powerful combination that reveals previously unimagined combinations, resulting in creations that break new ground and rewrite all the rules.

FORMAWALL Graphix Series with Directional Reveals allows you the freedom to **REVEAL** your true vision.

Now you have the ability to form unique, complex patterns and designs—that are also easy to install—by combining horizontal, vertical and diagonal reveals in a single component insulated metal panel. The array of possibilities is limited only by where you draw the line.

Featuring a steel face and liner, foamed-in-place insulation and CENTRIA's proprietary Advanced Thermal and Moisture Protection (ATMP®) technology, FORMAWALL Graphix Series is just one more way CENTRIA continues to lead the metal wall and roof industry. Our product innovations help you make your designs a reality with products that offer the highest levels of performance, aesthetics, sustainability and value.





“You never change things by fighting the existing reality.
To change something, build a new model that makes the existing model obsolete.” — Richard Buckminster Fuller

FORMAWALL GRAPHIX SERIES with Directional Reveals

Reveal True Vision. Reveal True Imagination.

True vision is seeing something that isn't there—yet. It is seeing something that others haven't even imagined—yet. But to reveal true vision requires real tools.

At CENTRIA we give you the tools to create that moment of aesthetic revelation. Imagine a single panel that can be customized to look like up to 24 smaller ones. Each with its own reveal—or combination of reveals—and in its own color, if you so choose. You also choose whether to install the panels vertically or horizontally, and how to position the directional reveals to make your vision a reality.

Reveal True Performance.

True performance is revealed in the innovative science behind FORMAWALL Graphix Series. Designed with CENTRIA's Advanced Thermal and Moisture Protection (ATMP®) technology, the FORMAWALL Graphix Series architectural insulated metal panel system provides the most advanced protection from air and water penetration, along with maximum thermal performance—all in one component.

true vision. true imagination.

Sloped Directional Reveals

One reveal. Any angle.

Reveals make patterns possible. And the ability to create patterns means a virtually infinite number of design possibilities are yours.

FORMAWALL Graphix Series with Sloped Directional Reveals makes it possible to create a sloped reveal within a panel module, creating the appearance of two separate panels with a single panel assembly.

HORIZONTAL & VERTICAL PANELS

Reveal placement – A single sloped reveal can be placed at any angle along the face of the panel. The sloped reveal must be placed a minimum of 3" away from the panel side joint. It cannot intersect the panel side joint. The ½" reveal is standard and optional reveals are available from 1" to 6" in ½" increments.

Panel sizes – Panels are available from 10" to 40" wide and from 4' to 16' long, and 2", 2.5" and 3"-T thick.

Color / texture combinations – The panel can be designed utilizing various color and texture combinations including smooth and embossed face textures and a virtually limitless color palette.



Positive Sloped Reveal

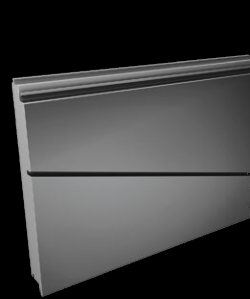

Negative Sloped Reveal



Positive Sloped Reveal



Negative Sloped Reveal

Red lines indicate where each Graphix Series panel is located

Unlock your creativity with Graphix Series Sloped Reveals. Now, you can truly focus on aesthetics without worrying about creating a complicated installation that drives up project costs.

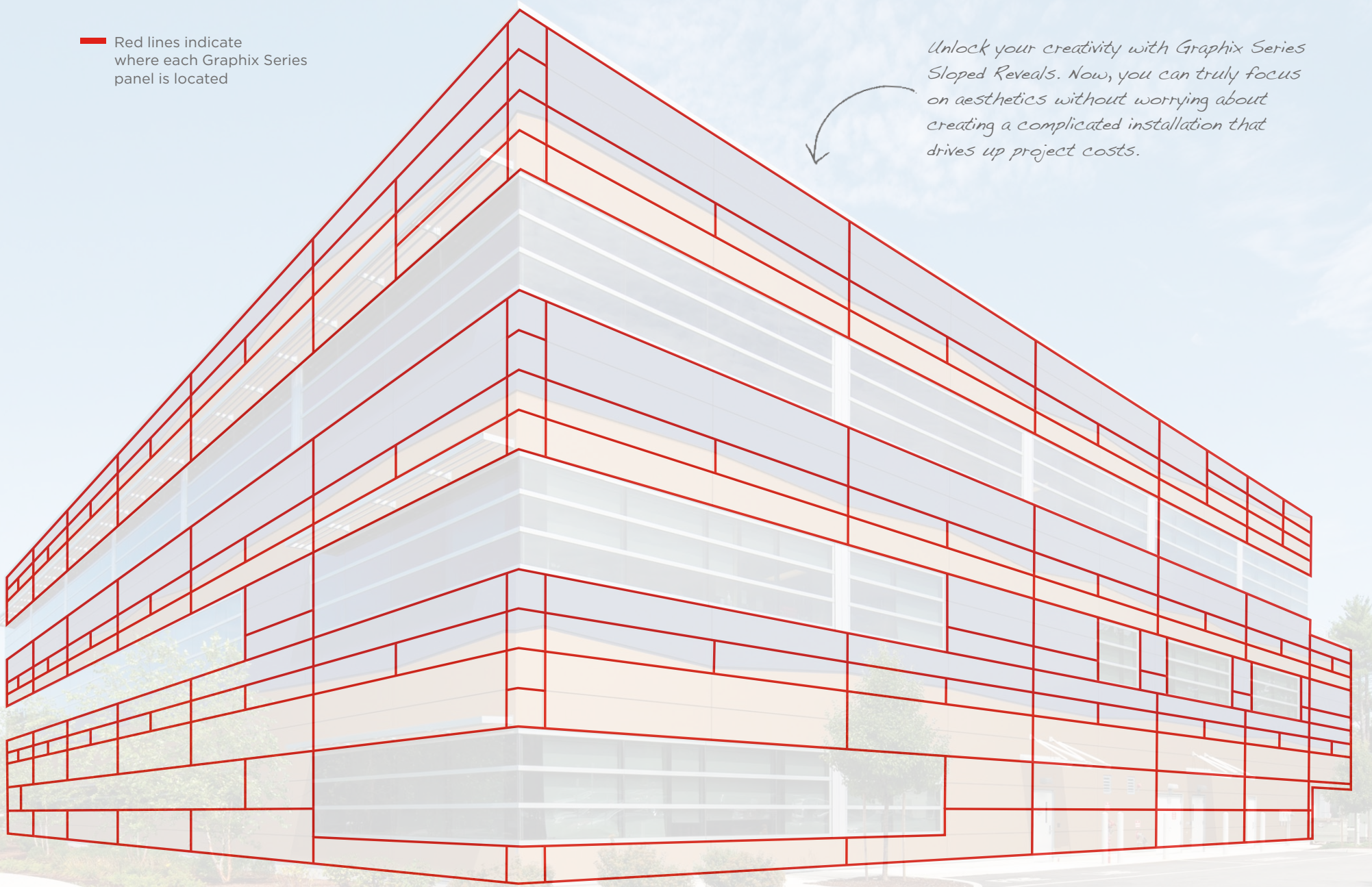



Type X Directional Reveals

The look of multiple panels. The ease of one.

Two different orientations and the illusion of multiple panels lead to fantastic design opportunities.

Type X Directional Reveals on horizontal panels create the appearance of up to three separate panels within a single panel module.

Type X Directional Reveals on vertical panels can create the appearance of up to 12 separate panels within a single panel length.

HORIZONTAL PANEL

Reveal placement - One or two Type X Reveals can be placed anywhere along the length of the face of the panel. The Type X Reveal must be placed a minimum of 10" away from the side joint or from another Type X Reveal. The ½" reveal is standard and optional reveals are available from 1" to 6" in ½" increments.

Panel sizes - Panels are available in lengths from 4' to 20' long and 2", 2.5" and 3"-T thick. The length may be limited based on the panel face texture selected. Overall panel modules may vary from 10" - 40". For panel modules availability, please refer to the chart on **page 18**.

Color / texture combinations - The panel can be designed utilizing various color and texture combinations, including smooth, embossed and striated face textures and a virtually limitless color palette.

VERTICAL PANEL

Reveal placement / sizes - Up to 11 Type X Reveals can be placed anywhere within the module of the panel. The Type X Reveal must be placed a minimum of 12" away from the end joint or from another Type X Reveal. Reveal sizes are 5/8".

Panel sizes - Panels are available in lengths from 4' to 20' long and 2", 2.5" and 3"-T thick. The length may be limited based on the panel face texture selected. Overall panel modules may vary from 10" - 40". For panel modules availability, please refer to the chart on **page 20**.

Color / Texture Combinations - Only one color / texture combination can be used with this reveal type.



One Type X Reveal



Two Type X Reveals



One Type X Reveals



Up to 11 Type X Reveals

Using any other wall panel system, this design would require 205 panels. With Graphix Series Type X Directional Reveals, that number is cut in half.

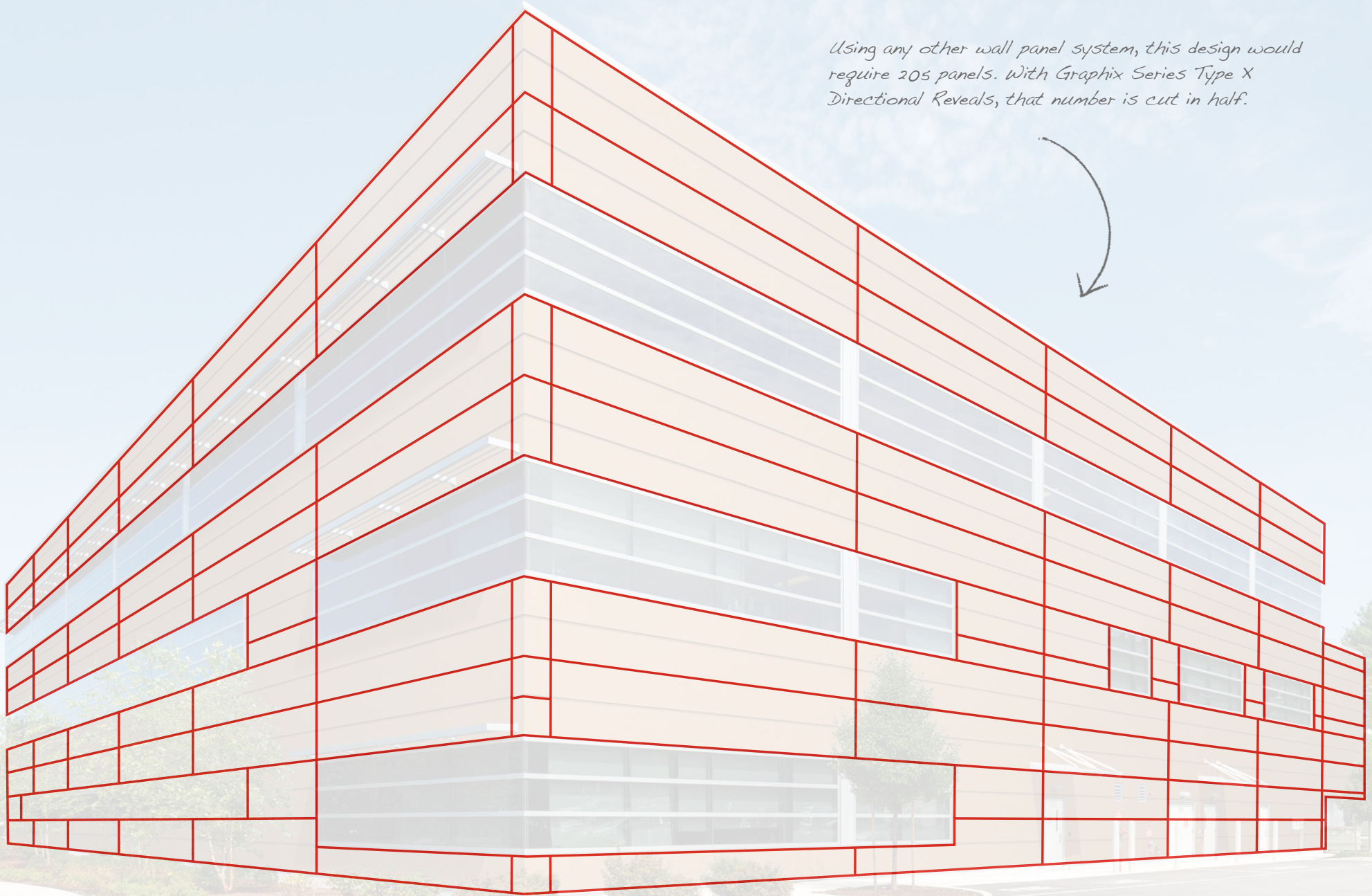



Type Y Directional Reveals

The simplicity of one panel. The amazing possibilities of multiples.

With Type Y Directional Reveals, the design aesthetic of multiple panels is combined with the installation simplicity of a single panel.

Type Y Directional Reveals on horizontal panels create the appearance of up to 12 separate panels within a single panel length.

Type Y Directional Reveals on vertical panels create the appearance of up to 3 separate panels within a single panel module.

HORIZONTAL PANEL

Reveal placement - Up to 11 Type Y Reveals can be placed anywhere within the module of the panel. The Type Y Reveal must be placed a minimum of 12" away from the end joint or from another Type Y Reveal. Reveal sizes are 5/8".

Panel sizes - Panels are available in lengths from 4' to 20' long and 2", 2.5" and 3"-T thick. The length may be limited based on the panel face texture selected. Overall panel modules may vary from 10" - 40". For panel modules availability, please refer to the chart on **page 18**.

Color / texture combinations - Only one color / texture combination can be used with this reveal type.

VERTICAL PANEL

Reveal placement / sizes - One or two Type Y Reveals can be placed anywhere along the length of the face of the panel. The Type Y Reveal must be placed a minimum of 10" away from the side joint or from another Type Y Reveal. The 1/2" reveal is standard and optional reveals are available from 1" to 6" in 1/2" increments.

Panel sizes - Panels are available in lengths from 4' to 20' long and 2", 2.5" and 3"-T thick. The length may be limited based on the panel face texture selected. Overall panel modules may vary from 10" - 40". For panel modules availability, please refer to the chart on **page 20**.

Color / Texture Combinations - The panel can be designed utilizing various color and texture combinations including smooth, embossed and striated face textures and a virtually limitless color palette.



One Type Y Reveal



Up to 11 Type X Reveals



One Type Y Reveals



Two Type Y Reveals

Featuring Graphix Series Type Y Directional Reveals, the building façade elevations below include just 11 joints for each row of panels and 175 panels. With any other metal panel system, the same design would require 21 joints and 350 panels.

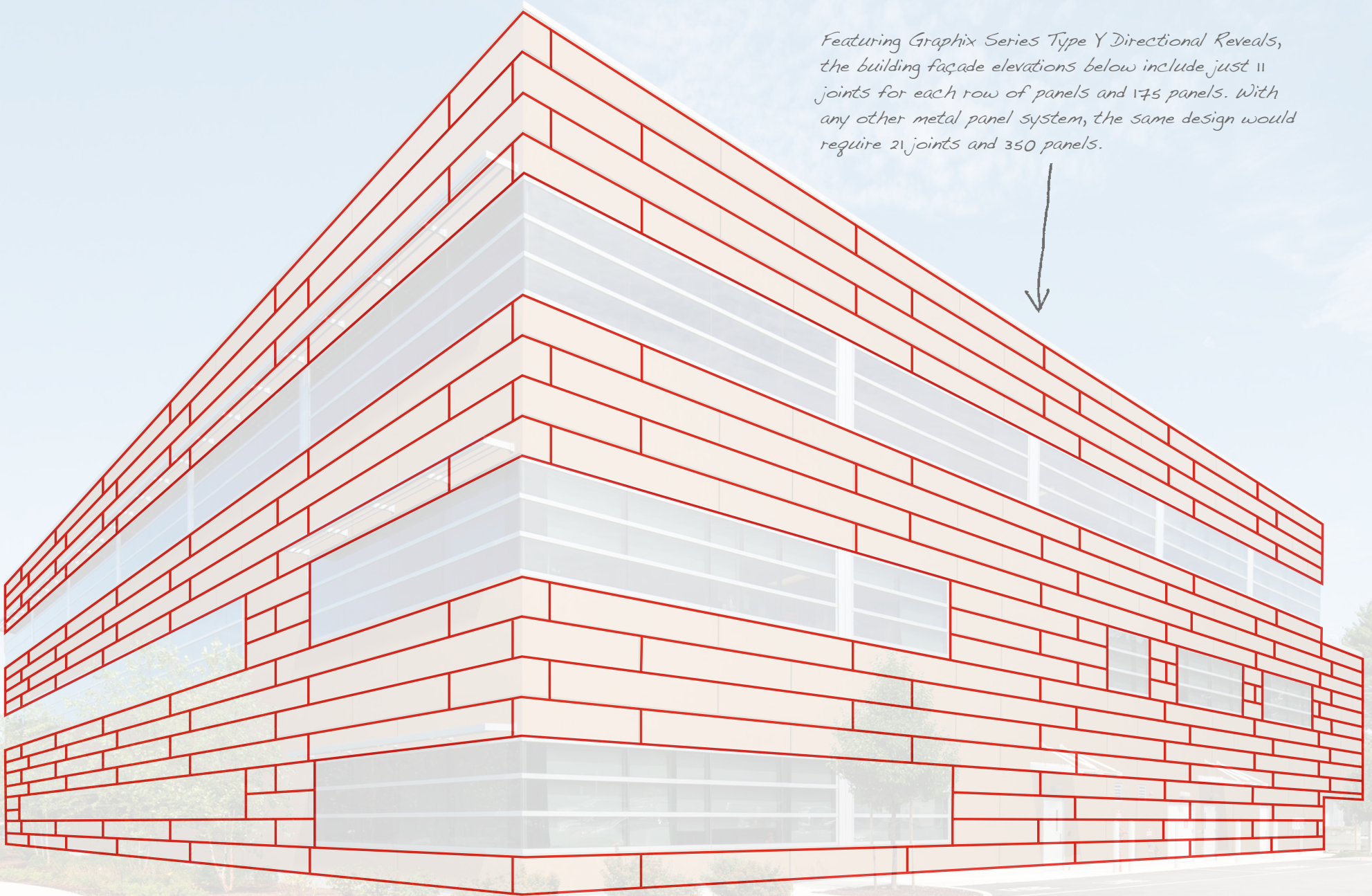



Type XY Directional Reveals

Revealing multiple design possibilities with a single panel.

Reveal your true originality and create distinctive design elements by combining FORMAWALL Graphix Series X and Y Reveals in multiple colors, textures and patterns. Both the horizontal and vertical reveals offer the illusion of up to 24 separate panels with a single panel module.

HORIZONTAL PANEL

Reveal placement - One Type X reveal and up to 11 Type Y Reveals can be placed within the module of the panel. The Type X Reveal can be a minimum of 10" from the side joint. The Type Y Reveal must be placed a minimum of 12" away from the end joint or from another Type Y Reveal.

Panel sizes - Panels are available in lengths from 4' to 20' long and 2", 2.5" and 3"-T thick. The length may be limited based on the panel face texture selected. Overall panel modules may vary from 10" - 40". For panel modules availability, please refer to the chart on **page 18**.

Color / texture combinations - The panel can be designed utilizing various color and texture combinations including smooth and embossed face textures and a virtually limitless color palette.



One Type X Reveal
Up to 11 Type Y Reveals

VERTICAL PANEL

Reveal placement / sizes - One Type Y reveal and up to 11 Type X Reveals can be placed within the module of the panel. The Type Y Reveal must be a minimum of 10" from the side joint. The Type X Reveal must be placed a minimum of 12" away from the end joint or from another Type X Reveal.

Panel sizes - Panels are available in lengths from 4' to 20' long and 2", 2.5" and 3"-T thick. The length may be limited based on the panel face texture selected. Overall panel modules may vary from 10" - 40". For panel modules availability, please refer to the chart on **page 20**.

Color / Texture Combinations - The panel can be designed utilizing various color and texture combinations including smooth and embossed face textures and a virtually limitless color palette.



Up to 11 Type X Reveals
One Type Y Reveal

Here, 21 panels provide the look of 64.

What looks like 63 panels is achieved with only 21.

The combination of XY Directional Reveals enables you to create complex patterns without a complicated installation.

This wall design provides the look of 151 individual panels but only requires 36.

This wall pattern would require 192 panels with any other wall system. With Graphix Series, it can be achieved with just 48.

Overall, using any other wall system, these two elevations would require 470 individual panels. Graphix Series with XY Directional Reveals cuts that number down to just 126.

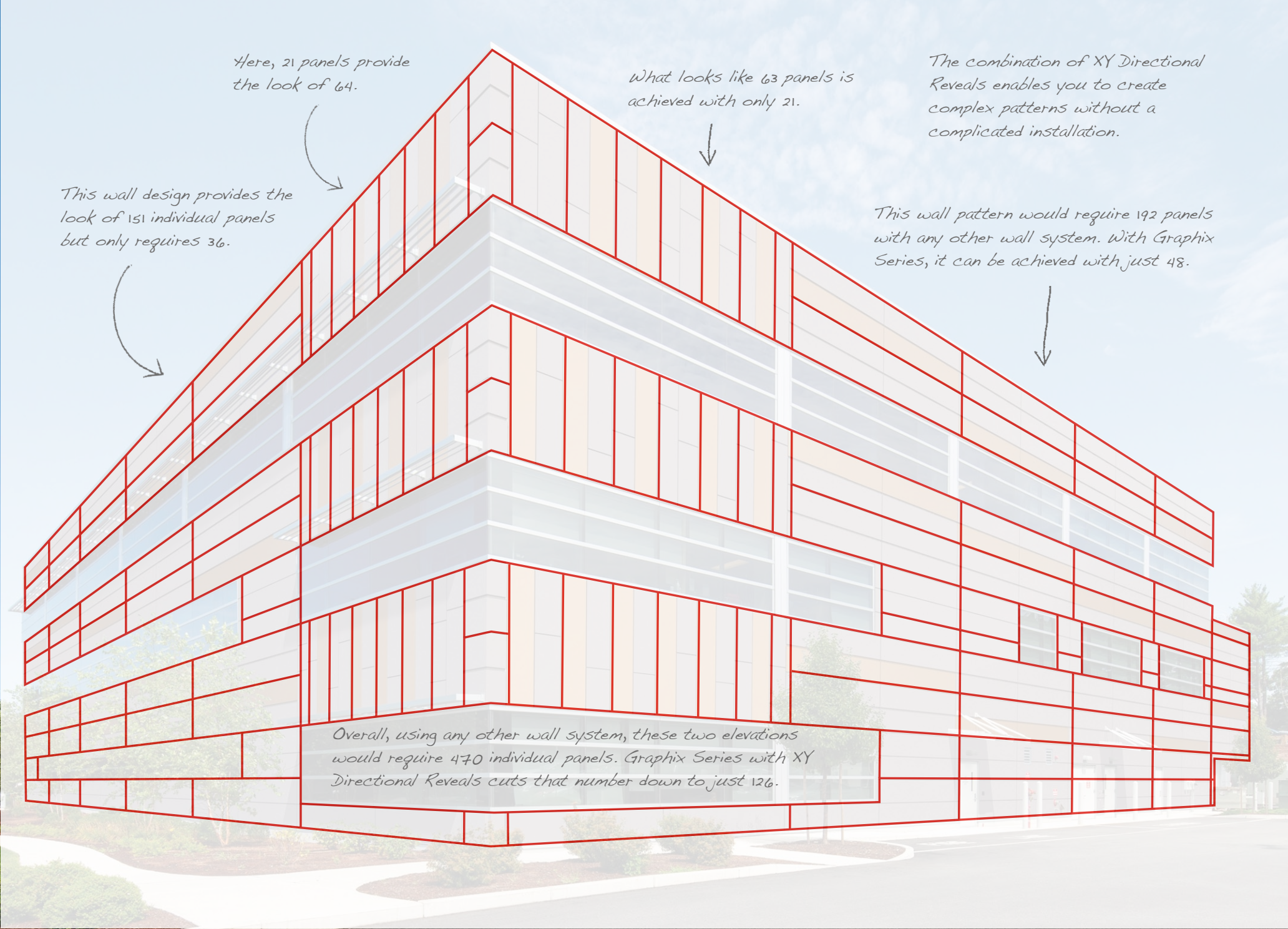



Limitless Reveal Combinations

Taking one panel in virtually any direction.

As an architectural technique, a **reveal** can lend intriguing and unexpected elements to your design.

Combine FORMAWALL Graphix Series Directional Reveals in almost any arrangement you can imagine. The composition is entirely up to you. With the ability to combine all of CENTRIA's FORMAWALL Graphix Series Directional Reveals in virtually limitless combinations, the creative possibilities truly reach new heights. Different angles, different textures, different colors mean a mosaic — and a building — that is unlike any other.

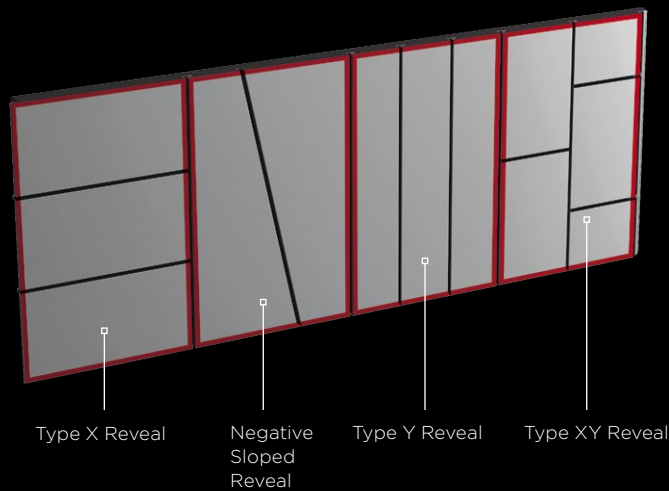

VERTICAL PANELS

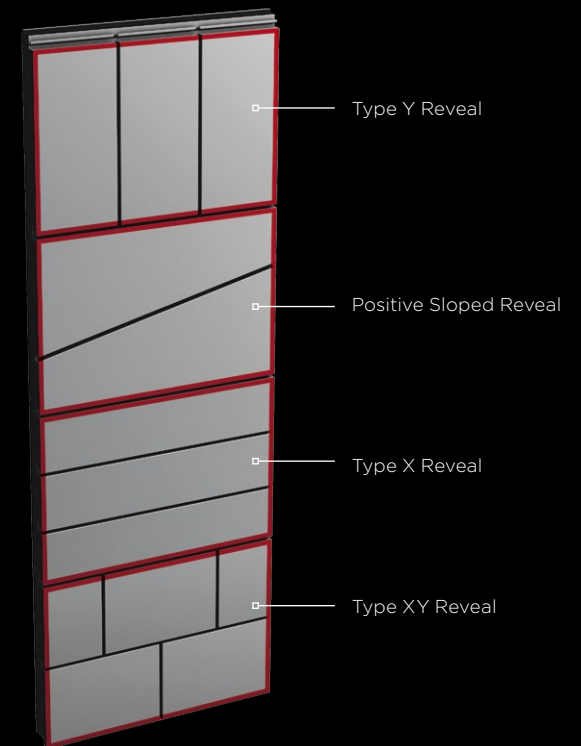

HORIZONTAL PANELS

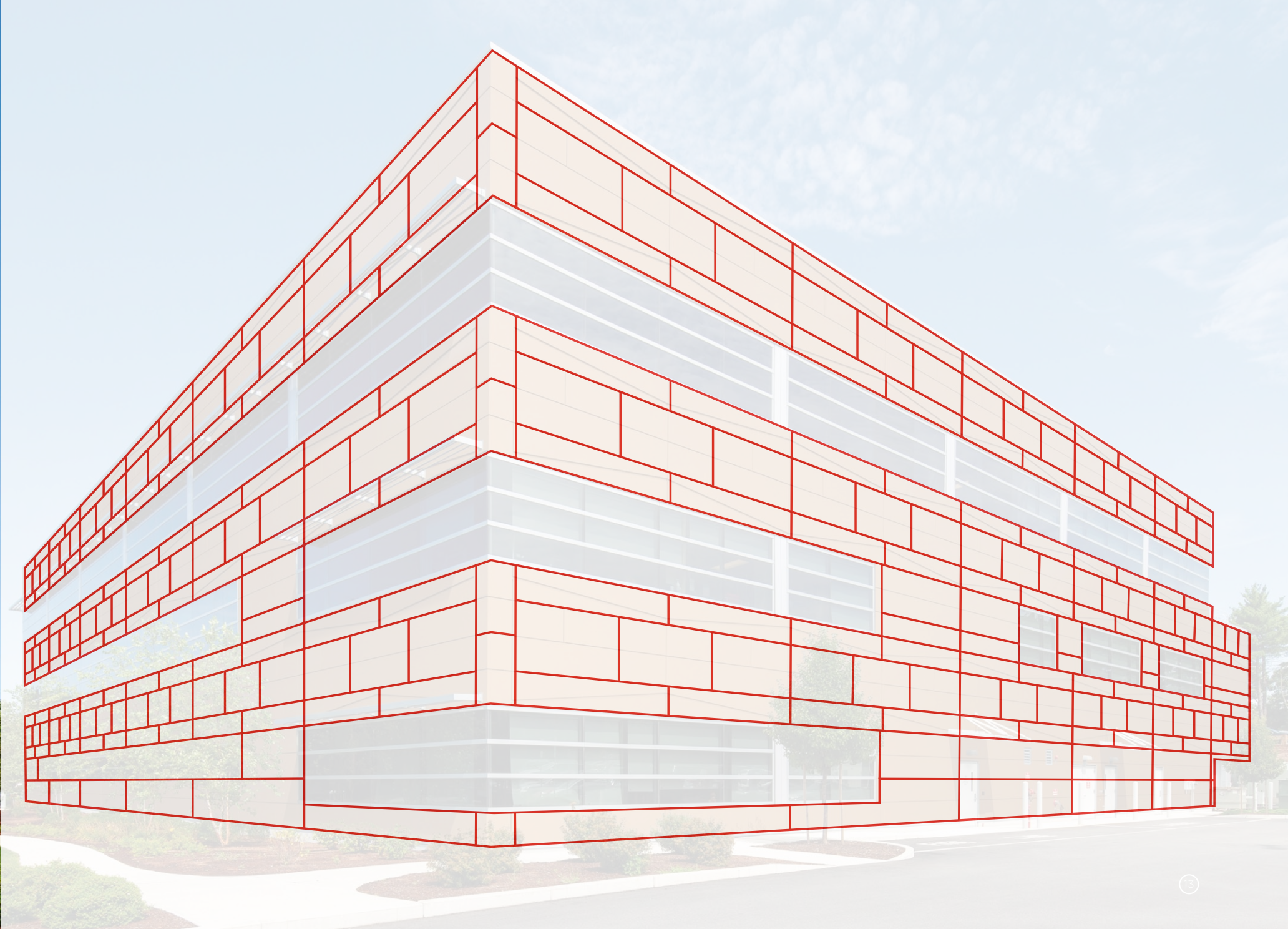



FWGS Performance & Joinery

FORMAWALL Graphix Series with Directional Reveals is a single component wall system that features a steel face and liner, foamed-in-place insulation and CENTRIA's proven pressure-equalized, vented and dry-sealed joinery. What makes FORMAWALL Graphix Series with Directional Reveals unique is the segmented Graphix joints. With fewer joints, there are fewer opportunities for air and water infiltration. The end result is the most advanced thermal and moisture protection available on the market and a wall that performs as well as it looks.

ATMP

CENTRIA's proprietary Advanced Thermal and Moisture Protection (ATMP®) technology is the science behind the wall that makes Formwall Graphix Series with Directional Reveals function at a high level. CENTRIA's ATMP technology means a wall system that is completely factory foamed, providing superior thermal and moisture control. A single component wall system without air spaces between the insulation and the exterior rain screen. A wall system with pressure-equalized horizontal joinery that creates a barrier against water infiltration. And a wall system that features insulation installed outboard of the studs, minimizing conductance and assuring optimal thermal performance.

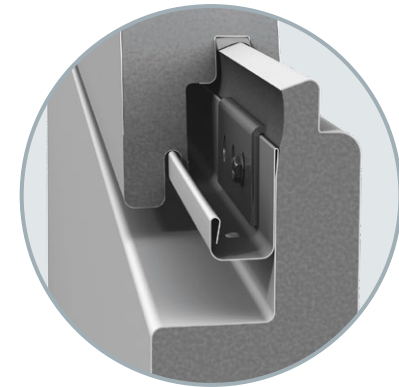

Foamed-In-Place Manufacturing

- Completely fills all voids in the panel joinery, helping ensure the panel will not have any cold spots, reducing the risk of condensation, and resulting in efficient, consistent thermal performance.
- Provides a stronger, better foam-to-metal bond since the foam chemically reacts with the metal.
- Foam is encapsulated in metal skins, which means no reduction in R-values.

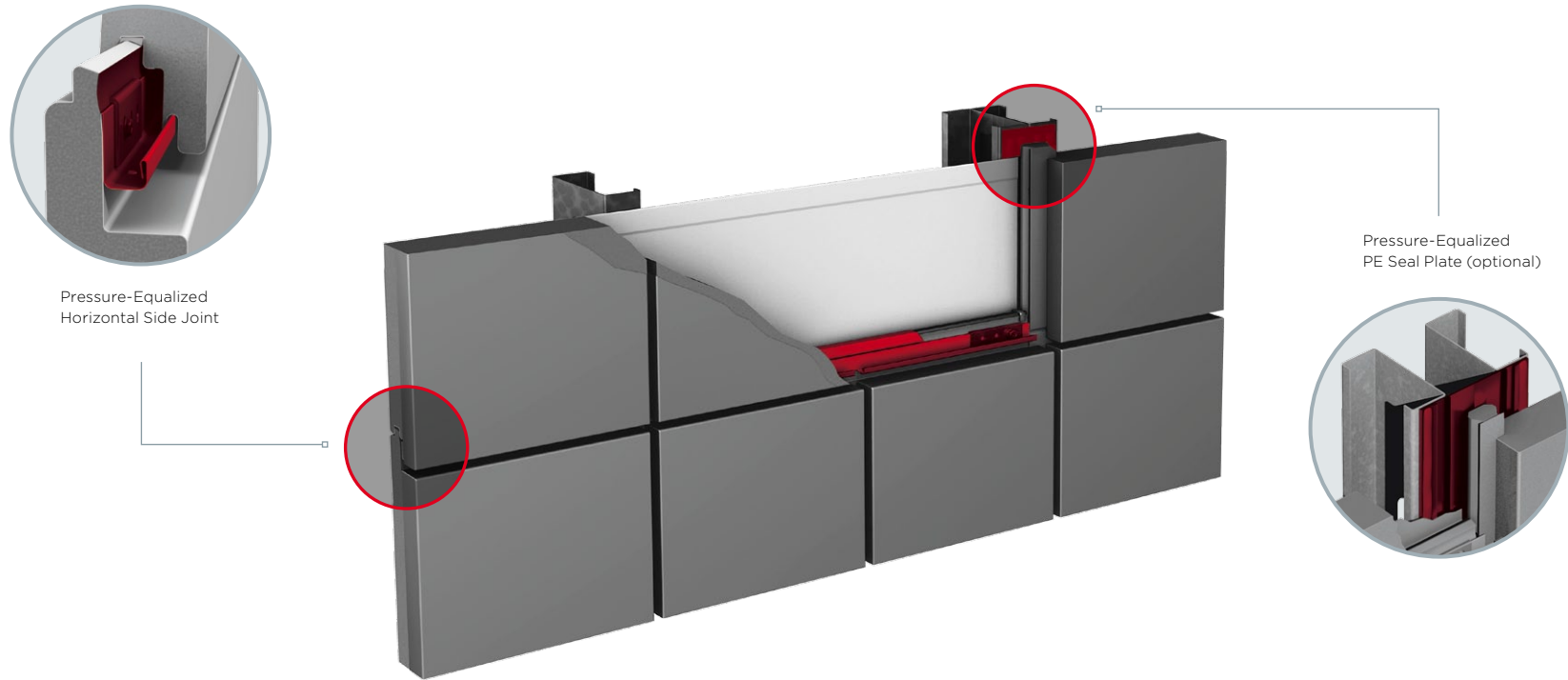

Pressure-Equalized Vertical and Horizontal Joinery

Pressure-equalized joinery has significant benefits when compared to a barrier seal system. Pressure-equalized joinery provides long-term protection that requires minimal maintenance, whereas a barrier seal system

depends on the accurate and consistent placement of the sealant, and may also require periodic maintenance. In addition, a vented horizontal joint is designed for pressure equalization, and, even in the

presence of an imperfect air barrier, the pressure-equalized joinery maintains the system's performance integrity. With a barrier seal system, imperfections in the air barrier can lead to water infiltration.

FWGS Features & Benefits

Formawall Graphix Series with Directional Reveals is the ultimate combination of performance, aesthetic flexibility and efficiency.

- Creative freedom is provided by horizontal, vertical and diagonal reveals
- Lower installed cost is achieved by reducing the number of separate panels that would be installed to cover the same square footage
- Overall performance is improved by reducing the opportunity for air/water infiltration at actual panel to panel joints
- The amount of flashing and sealants used on a project is reduced

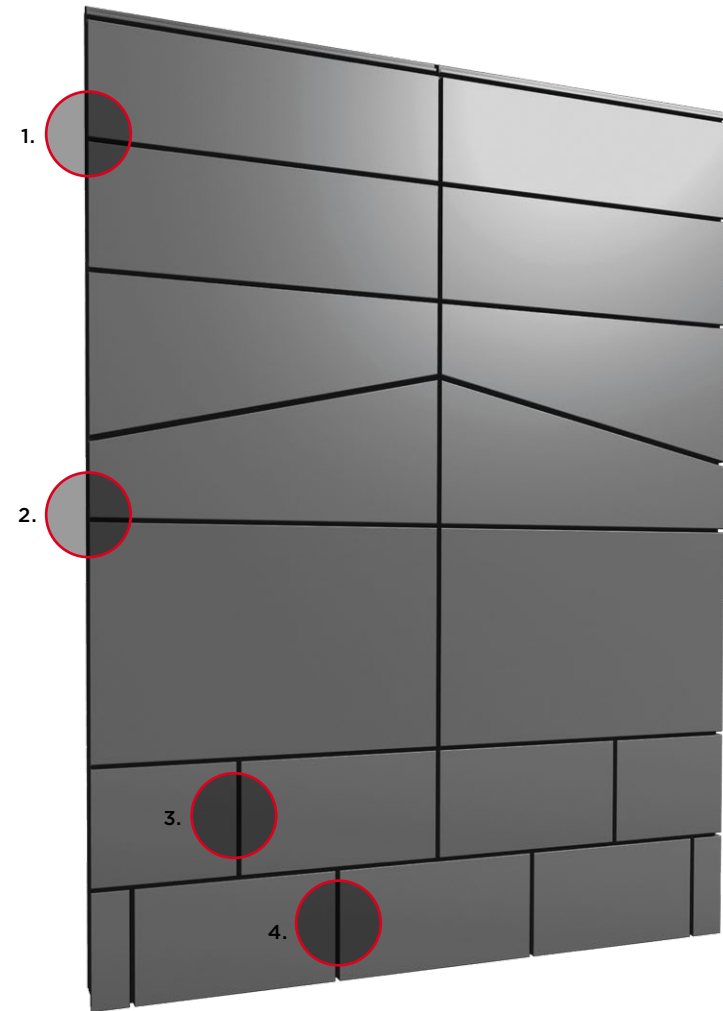



Actual Side Joint

As has been illustrated in this brochure, the FWGS panel to panel side joint is engineered to perform at or beyond the standards of performance that have been set in the industry.

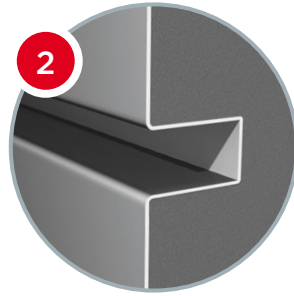

Directional Reveal

The FORMAWALL Graphix Series Directional Reveals have been engineered to mimic that of an actual reveal, so that efficiencies and quality could be improved, while providing a level of creativity never before seen in the insulated panel marketplace.



Actual End Joint

End joints long have been a weak point in an architectural insulated metal panel system. No more. Today, CENTRIA Formawall panels offer not only a gasketed joint, but also an Insulated Metal Vertical joint, which provides a metal reveal to the vertical joint without the addition of exterior sitelines. Now, the horizontal and vertical joints of the panel system will look alike.

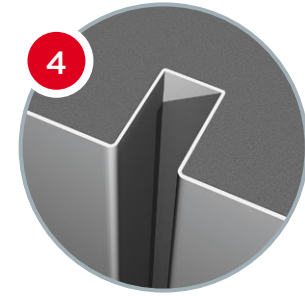

Directional Reveal

The FORMAWALL Graphix Series Directional Reveals have been engineered to mimic that of an actual panel end joint, so that efficiencies and quality could be improved, while providing a level of creativity never before seen in the insulated panel marketplace.

Now, horizontal, vertical and diagonal lines can be made through the utilization of FORMAWALL Graphix Series with Directional Reveals. No other insulated metal panel system offers this level of flexibility.

Horizontal FWGS Capabilities Matrix

All FWGS horizontal panels/all reveal types

THICKNESS [millimeters]	R VALUE	FACE SUBSTRATE	FACE GAGE [millimeters]	LINER GAGE [millimeters]	LINER TEXTURE	SIDE JOINT REVEAL [millimeters]	END JOINT REVEAL [millimeters]
2" [51]	14 [U=.072]	G90	20 ga [0.91] 22 ga [0.76]	20 ga [0.91] 22 ga [0.76] 24 ga [0.60] 26 ga [0.48]	Embossed, planked	1/2" [12.7] (1" - 6" [25.4 - 152.4] in 1/2" [12.7] increments)	5/8" [16] gasket or IMV Optional IMV sizes (1", 2" or 3") [25.4, 51, 76]
				20 ga [0.91] 22 ga [0.76]	Embossed, flat or smooth, planked		
2.5" [64]	17 [U=.060]	G90	20 ga [0.91] 22 ga [0.76]	20 ga [0.91] 22 ga [0.76] 24 ga [0.60] 26 ga [0.48]	Embossed, planked	1/2" [12.7] (1" - 6" [25.4 - 152.4] in 1/2" [12.7] increments)	5/8" [16] gasket or IMV (1", 2" or 3") [25.4, 51, 76] Optional IMV sizes (1", 2" or 3") [25.4, 51, 76]
				20 ga [0.91] 22 ga [0.76]	Embossed, flat or smooth, planked		
3"-T [76]	22 [U=.046]	G90	20 ga [0.91] 22 ga [0.76]	20 ga [0.91] 22 ga [0.76] 24 ga [0.60] 26 ga [0.48]	Embossed, planked	1/2" [12.7] (1" - 6" [25.4 - 152.4] in 1/2" [12.7] increments)	5/8" [16] gasket or IMV Optional IMV sizes (1", 2" or 3") [25.4, 51, 76]
				20 ga [0.91] 22 ga [0.76]	Embossed, flat or smooth, planked		

Horizontal Panels

REVEAL TYPE	FACE TEXTURE	PANEL LENGTH [meters]	MAX # OF REVEALS	DIRECTIONAL REVEAL SIZE [millimeters]	MODULE [millimeters]	SEGMENT HEIGHT [millimeters]	SEGMENT LENGTH [meters]
Type X	Embossed, Flat	4' - 20' [1.2 - 6.1]	2	1/2" [12.7] (1" - 6" [25.4 - 152.4] in 1/2" [12.7] increments)	20" - 40" [508-1016]	10" - 30" [254 - 762]	4' - 20' [1.2 - 6.1]
	Smooth, Flat	4' - 16' [1.2 - 4.9]					4' - 16' [1.2 - 4.9]
	Embossed, Striated	4' - 20' [1.2 - 6.1]					4' - 20' [1.2 - 6.1]
	Smooth, Striated	4' - 20' [1.2 - 6.1]					4' - 20' [1.2 - 6.1]
Type Y	Embossed, Flat	4' - 20' [1.2 - 6.1]	11	5/8" [15.875]	10" - 40" [254-1016]	10" - 40" [254 - 1016]	1' - 19' [0.3 - 5.8]
	Smooth, Flat	4' - 20' [1.2 - 6.1]					1' - 19' [0.3 - 5.8]
Type XY	Embossed, Flat	4' - 20' [1.2 - 6.1]	2 X - 11 Y	Type X = 1/2" [12.7] (1" - 6" [25.4 - 152.4] in 1/2" [12.7] increments) Type Y = 5/8" [15.875]	20" - 40" [508-1016]	Type X = 10" - 30" [254 - 762] Type Y = 10" - 30" [254 - 762]	See above
	Smooth, Flat	4' - 16' [1.2 - 4.9]					
Sloped	Embossed, Flat	4' - 16' [1.2 - 4.9]	1	1/2" [12.7] (1" - 6" [25.4 - 152.4] in 1/2" [12.7] increments)	10" - 40" [254-1016]	3" - 37" [76.2 - 939.8]	4' - 16' [1.2 - 4.9]
	Smooth, Flat	4' - 16' [1.2 - 4.9]					4' - 16' [1.2 - 4.9]

Horizontal Panels

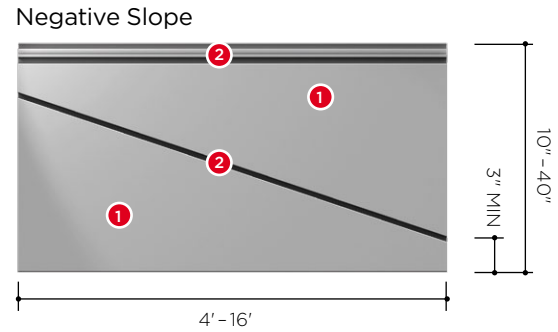
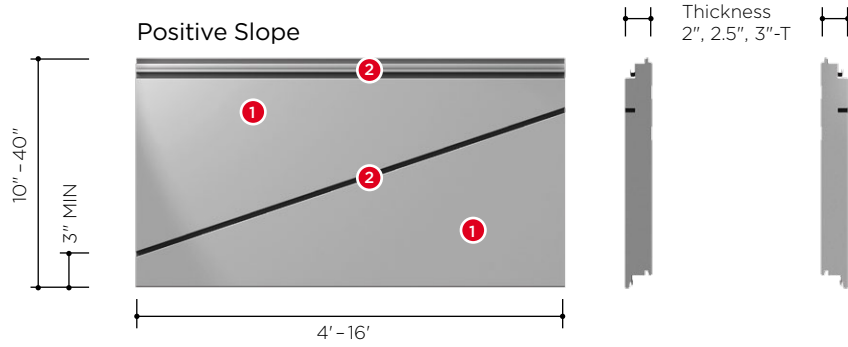

- Slope**
- 1 Up to 2 colors/textures
 - 2 .5"-1"-6" MAX (.5" INC)
1 REVEAL MAX

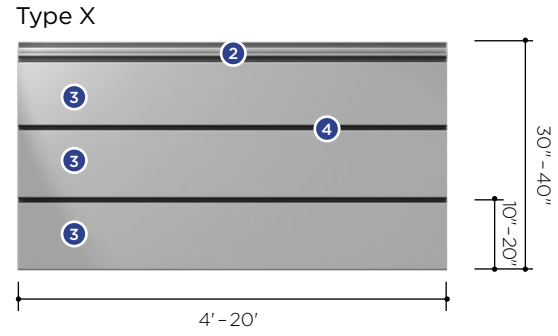
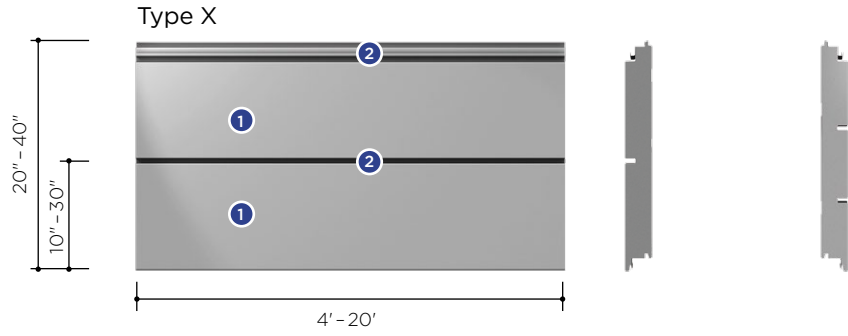

- Type X**
- 1 Up to 2 colors/textures
 - 2 .5"-1"-6" MAX (.5" INC)
1 REVEAL MAX
 - 3 Up to 3 colors/textures
 - 4 .5"-1"-6" MAX (.5" INC)
2 REVEALS MAX

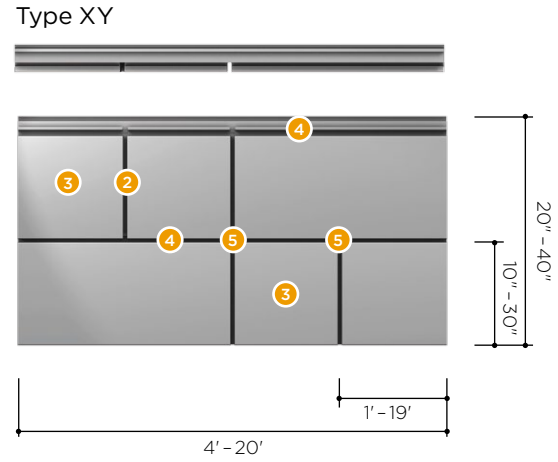
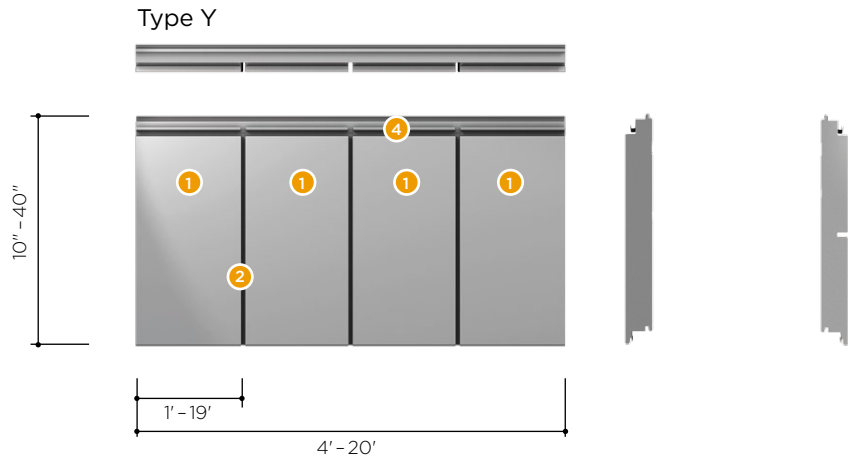

- Type Y/XY**
- 1 1 color/texture
 - 2 .625"
11 REVEAL MAX
 - 3 Up to 2 colors/textures
 - 4 .5"-1"-6" MAX (.5" INC)
1 REVEAL MAX
 - 5 STANDARD or
BOND PATTERN

Vertical FWGS Capabilities Matrix

All FWGS vertical panels/all reveal types

THICKNESS [millimeters]	R VALUE	FACE SUBSTRATE	FACE GAGE [millimeters]	LINER GAGE [millimeters]	LINER TEXTURE	SIDE JOINT REVEAL [millimeters]	STACK JOINT [millimeters]
2" [51]	14 [U=.072]	G90	20 ga [0.91] 22 ga [0.76]	20 ga [0.91] 22 ga [0.76] 24 ga [0.60] 26 ga [0.48]	Embossed, planked	1/8" [3.2] (1/4", 1/2", 1" - 6" [6.35 - 152.4] in 1/2" [12.7] increments)	5/8" [16] gasket or extrusion
				20 ga [0.91] 22 ga [0.76]	Embossed, flat or smooth, planked		
2.5" [64]	17 [U=.060]	G90	20 ga [0.91] 22 ga [0.76]	20 ga [0.91] 22 ga [0.76] 24 ga [0.60] 26 ga [0.48]	Embossed, planked	1/8" [3.2] (1/4", 1/2", 1" - 6" [6.35 - 152.4] in 1/2" [12.7] increments)	5/8" [16] gasket or extrusion
				20 ga [0.91] 22 ga [0.76]	Embossed, flat or smooth, planked		
3"-T [76]	22 [U=.046]	G90	20 ga [0.91] 22 ga [0.76]	20 ga [0.91] 22 ga [0.76] 24 ga [0.60] 26 ga [0.48]	Embossed, planked	1/8" [3.2] (1/4", 1/2", 1" - 6" [6.35 - 152.4] in 1/2" [12.7] increments)	5/8" [16] gasket or extrusion
				20 ga [0.91] 22 ga [0.76]	Embossed, flat or smooth, planked		

Vertical Panels

REVEAL TYPE	FACE TEXTURE	PANEL LENGTH [meters]	MAX # OF REVEALS	DIRECTIONAL REVEAL SIZE [millimeters]	MODULE [millimeters]	SEGMENT HEIGHT [millimeters]	SEGMENT LENGTH [meters]
Type X	Embossed, Flat	4' - 20' [1.2 - 6.1]	11	5/8" [15.875]	10" - 40" [254-1016]	10" - 40" [254 - 1016]	1' - 19' [1.2 - 5.8]
	Smooth, Flat	4' - 20' [1.2 - 6.1]					1' - 15' [1.2 - 4.6]
Type Y	Embossed, Flat	4' - 20' [1.2 - 6.1]	2	1/2" [12.7] (1" - 6" [25.4 - 152.4] in 1/2" [12.7] increments)	20" - 40" [508-1016]	10" - 30" [254 - 762]	4' - 20' [1.2 - 6.1]
	Smooth, Flat	4' - 16' [1.2 - 4.9]					4' - 16' [1.2 - 4.9]
	Embossed, Striated	4' - 20' [1.2 - 6.1]					4' - 20' [1.2 - 6.1]
	Smooth, Striated	4' - 20' [1.2 - 6.1]					4' - 20' [1.2 - 6.1]
Type XY	Embossed, Flat	4' - 20' [1.2 - 6.1]	2 Y - 11 X	Type X = 5/8" [15.875]	20" - 40" [508-1016]	Type X = 10" - 30" [254 - 762]	See above
	Smooth, Flat	4' - 16' [1.2 - 4.9]		Type Y = 1/2" [12.7] (1" - 6" [25.4 - 152.4] in 1/2" [12.7] increments)		Type Y = 10" - 30" [254 - 762]	
Sloped	Embossed, Flat	4' - 16' [1.2 - 4.9]	1	1/2" [12.7] (1" - 6" [25.4 - 152.4] in 1/2" [12.7] increments)	10" - 40" [254-1016]	3" - 37" [76.2 - 939.8]	4' - 20' [1.2 - 6.1]
	Smooth, Flat	4' - 16' [1.2 - 4.9]					4' - 16' [1.2 - 4.9]

Vertical Panels

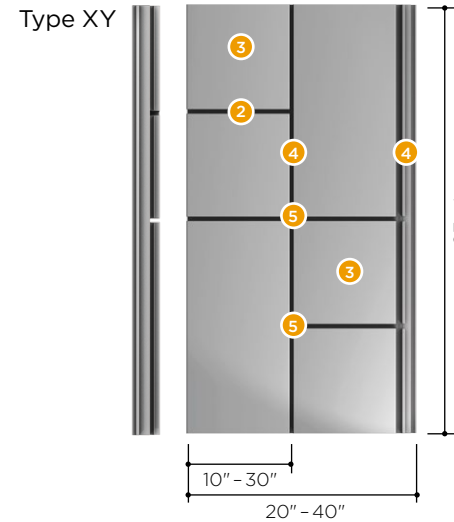
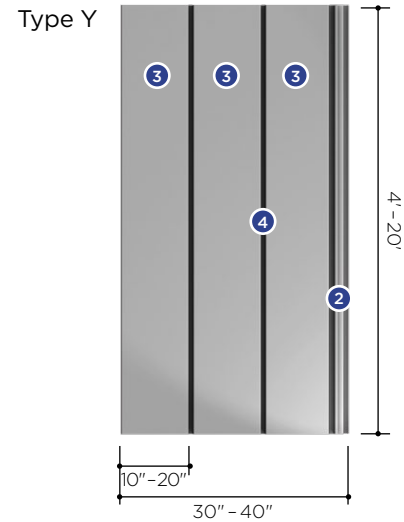
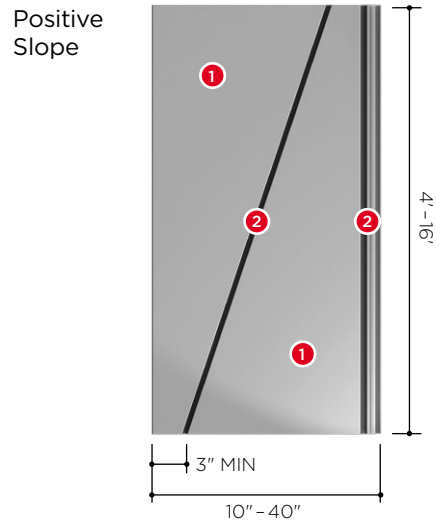
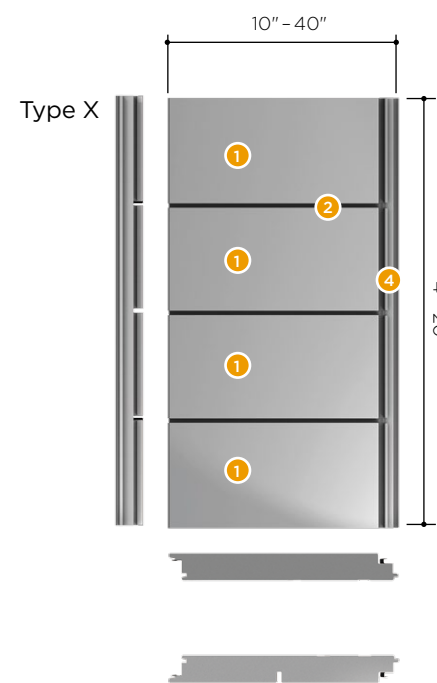
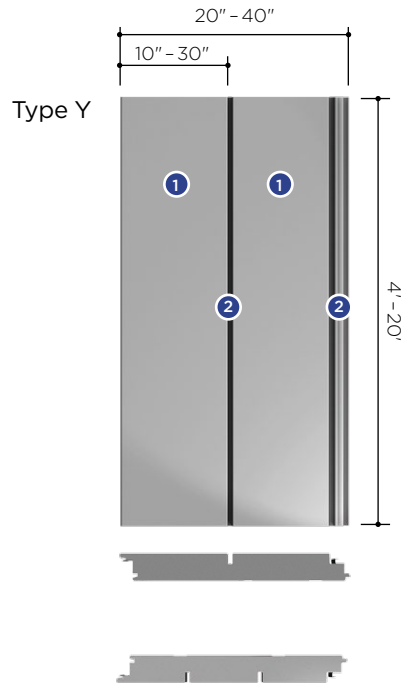
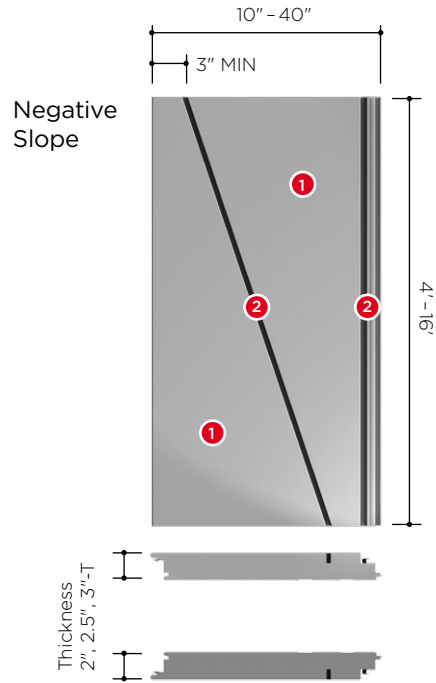

Slope

- 1 Up to 2 colors/textures
- 2 .5"-1"-6" MAX (.5" INC)
1 REVEAL MAX

Type Y

- 1 Up to 2 colors/textures
- 2 .5"-1"-6" MAX (.5" INC)
1 REVEAL MAX
- 3 Up to 3 colors/textures
- 4 .5"-1"-6" MAX (.5" INC)
2 REVEALS MAX

Type X/XY

- 1 1 color/texture
- 2 .625"
11 REVEAL MAX
- 3 Up to 2 colors/textures
- 4 .5"-1"-6" MAX (.5" INC)
1 REVEAL MAX
- 5 STANDARD or
BOND PATTERN

REVEAL – Exceptional Service and Support

Beyond product quality and innovation, the real value of working with CENTRIA is revealed through our exceptional service and support.

At CENTRIA, our products are aesthetically amazing, but what is revealed behind the wall is even more riveting. The latest scientific advances are what drives every aspect of new product development and are at the heart of our quest for continuous quality improvement. Our scientists work closely with experts in the commercial construction industry to conduct independent research and product testing. At CENTRIA we are committed to revealing better ways of producing products, as well as to providing the best in service and support. That means a

technically trained sales force and teams of engineering and design professionals that are available to troubleshoot, offer advice, and consult on the details of a project from start to finish. Working collaboratively, they can solve any design challenge.

CENTRIA's Dealer Network

CENTRIA's elite Dealer Network provides expert installation and construction services. We also offer in-house coil coating services for virtually unlimited color and texture choices, along with the best in quality control.

CENTRIA International

CENTRIA provides international customers with innovative building products, comprehensive services and project support. We have agents and offices in the United States, Central and South America, Europe, Southeast Asia, the Middle East and China.

- ★ CENTRIA Headquarters
- CENTRIA Sales Locations
- CENTRIA Dealer Locations
- CENTRIA Manufacturing Facilities
- Cambridge, OH
Ambridge, PA
Sheridan, AR
Frankfort, KY
- CENTRIA Product Innovation Center

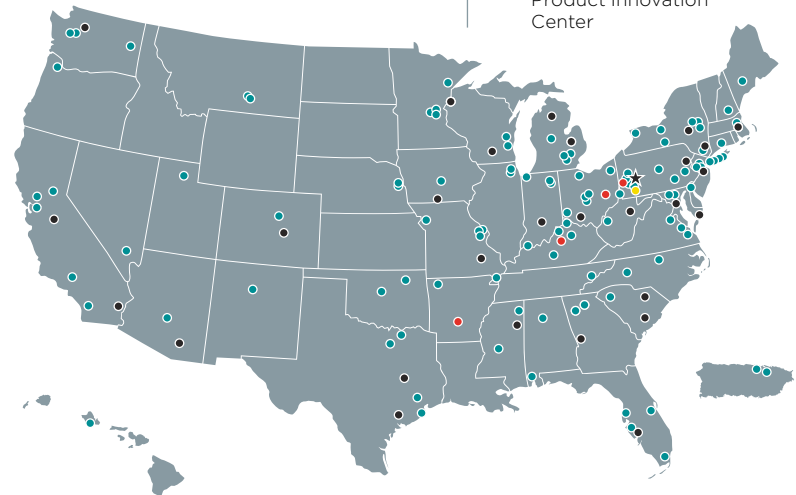

...forms

“Architecture is the learned game, correct and magnificent,
of forms assembled in the light.” – Le Corbusier

assembled
in the light.



CENTRIA



CENTRIA

www.CENTRIperformance.com

1.800.759.7474

1005 Beaver Grade Road
Moon Township
PA 15108-2944

Phone: 412.299.8000
Fax: 412.299.8317

Connect
with us:

